

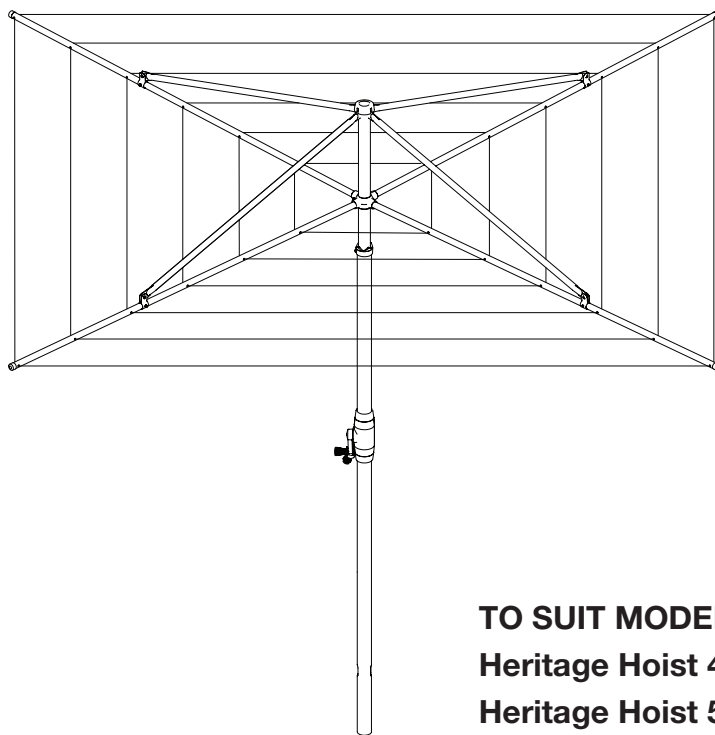

Hills® Heritage™ Hoist

Supa™ A Hoist

Arm Stay and Cap Assembly
Owner's Manual



TO SUIT MODELS:
Heritage Hoist 4
Heritage Hoist 5
Supa A4 Hoist
Supa A5 Hoist

Pack Contents

Part name	Qty.
Supa A4 Hoist Arm Stay and End Cap	1
OR	
Supa A5 Hoist Arm Stay and End Cap	1
OR	
Heritage 4 Hoist Arm Stay and End Cap	1
OR	
Heritage 5 Hoist Arm Stay and End Cap	1

To Remove:

IMPORTANT: Support the Hoist arms and stays before removing any screws and nuts.

- Remove the wire clothesline from the Hoist. Do not discard as it is to be re used. Take note of how the wire is fitted. Wear protective safety glasses when removing the wire.
- Loosen screws **203** and nuts **409** in the Top Cap assembly. Remove the screw and nut completely on the stay that is being replaced. Do not discard as they are to be reused.
- Remove the Tube Stay **794** and if fitted the Rod Stay **789** from the top of the standard. Pull the Arm **793** out of the Cross. Discard parts.

To Replace:

- Insert the new arm **793** into the cross and fit the tube stay **794** into the Top Cap of the standard **795**. If required place Rod Stay **789** onto the inner most staple of the Arm and then position the other end underneath the Top Cap. Re fit to the top using the screw **203** and nut **409**.
- Tighten up all screws holding the Stays to the Top Cap securely.
- Refit the wire clothesline starting with the inside line first. Take care to keep the arms square to each other. Always wear protective glasses when 'wiring-up' your clothesline.

Raise the head of the Hoist at least six full turns so that it is free to rotate.

NOTE: Never leave the Hoist with the cross and wind brake engaged. Use the brake only when you are pegging out the washing and taking it off.

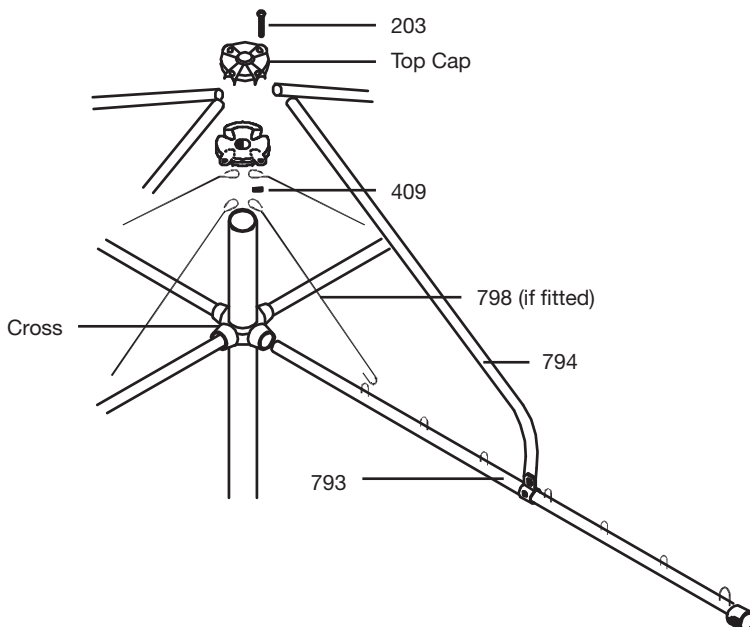

To Remove:

IMPORTANT: Support the Hoist arms and stays before removing any screws and nuts

- Remove the wire clothesline from the Hoist. Do not discard as it is to be re used. Take note of how the wire is fitted. Wear protective safety glasses when removing the wire.
- Undo the screw **204** and nut **447**. Remove the Top Cap **790** from the top of the standard. Do not discard as they are to be re used.
- Un hook the Tube Stay **794** from the top of the standard **795** and pull the arm **793** out of the cross. Discard old arm and stay.

To Replace:

- Insert the new Arm **793** into the Cross and hook the Tube Stay **794** to the top of the standard **795**.
- Fit the Top Cap **790** back onto the top of the standard. Re fit screw **204** and nut **447** and fasten securely.
- Refit the wire clothesline starting with the inside line first. Take care to keep the arms square to each other. Always wear protective glasses when 'wiring-up' your clothesline.

Raise the head of the Hoist at least six full turns so that it is free to rotate.

NOTE: Never leave the Hoist with the cross and wind brake engaged. Use the brake only when you are pegging out the washing and taking it off.

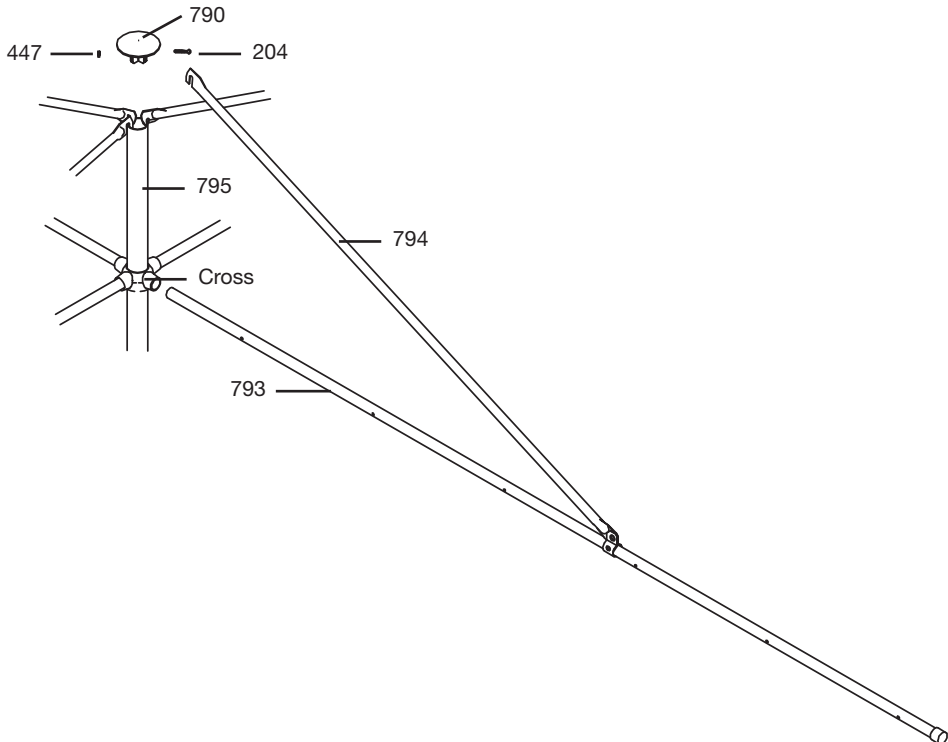

Hills Guarantee

Hills Industries Limited undertakes that if any part of its manufacture has failed to operate correctly due to faulty workmanship or defective material, it will repair or replace the part free of cost for a period of ONE (1) year from date of purchase of the article, given fair wear and tear. Evidence of unfair usage or incorrect adjustment by the owner will void this promise.

Hills Industries Limited will not be responsible for any costs in connection with freight or postage, or for expenditure necessary to dismantle the article, replace the part in position and re assemble the article.

This guarantee is in addition to any legal rights or remedies conferred on the consumer.

Hills Industries Limited does not recommend the application of a 'canopy' on any of their outdoor dryer range.

Unless any addition or attachment to this product has Hills specific approval or is sold as a Hills product the warranty on this product is waived. The product is designed to perform a specific task under established test loads and unauthorised attachments may produce stresses for which the design is not appropriate.

Designs, specifications and colours are subject to change without notice.

Please retain this Owner's Manual. Record the following information from the carton for future reference.

Product Number:.....

Date of purchase:.....

Name and location of store:.....

.....

Hills Contacts

As a proudly Australian company we are committed to provide you with complete customer satisfaction. If you have questions about this product or find there are missing or damaged parts please call one of our Hills Consumer Advice Centres:

Australia

1300 300 564

New Zealand

09 262 3052

or visit www.hills.com.au



This product is designed and tested under a Quality System which complies with ISO 9001.

Made in China



Hills Industries Limited

A.B.N. 35 007 573 417

Issue March 2009 – PD2284a